

Hohe Rändelschrauben· DIN 464 EH 24790.



Produktbeschreibung

Rändelschrauben sind aus einem Stück hergestellt. Entgegen dem Normblatt sind sie generell mit Gewinde bis zum Kopf und ohne Einstich am Gewindeende gefertigt.

Werkstoff

- Stahl, brüniert, Güte 5.8
- Rostfreier Stahl 1.4305, matt gestrahlt

Weiterführende Informationen

Hinweise

Rändelteilung und Rändeltiefe können von der DIN abweichen.

Maßzeichnung

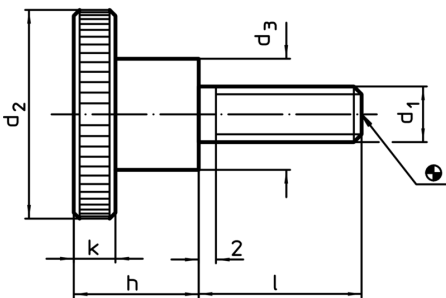

Bestellinformationen

d ₁	l	d ₂	Abmessungen			h	k	[g]	Art.-Nr.
			d ₃	[mm]					
Stahl									
M 3	6	12	6		7,5	2,5	3,7	24790.0074	
M 3	10	12	6		7,5	2,5	3,8	24790.0076	
M 3	12	12	6		7,5	2,5	4,0	24790.0077	
M 3	16	12	6		7,5	2,5	4,0	24790.0079	
M 3	20	12	6		7,5	2,5	4,5	24790.0081	
M 4	5	16	8		9,5	3,5	7,7	24790.0092	
M 4	8	16	8		9,5	3,5	7,9	24790.0094	
M 4	10	16	8		9,5	3,5	8,1	24790.0095	
M 4	12	16	8		9,5	3,5	8,3	24790.0096	
M 4	16	16	8		9,5	3,5	8,4	24790.0098	
M 4	20	16	8		9,5	3,5	9,1	24790.0100	
M 4	25	16	8		9,5	3,5	9,0	24790.0102	
M 5	6	20	10		11,5	4,0	14,0	24790.0112	
M 5	8	20	10		11,5	4,0	15,0	24790.0113	
M 5	10	20	10		11,5	4,0	15,0	24790.0114	
M 5	12	20	10		11,5	4,0	15,0	24790.0115	
M 5	16	20	10		11,5	4,0	16,0	24790.0117	
M 5	20	20	10		11,5	4,0	16,0	24790.0119	
M 5	25	20	10		11,5	4,0	17,0	24790.0121	
M 5	30	20	10		11,5	4,0	17,0	24790.0123	
M 6	8	24	12		15,0	5,0	28,0	24790.0132	
M 6	10	24	12		15,0	5,0	27,0	24790.0133	
M 6	12	24	12		15,0	5,0	28,0	24790.0134	
M 6	16	24	12		15,0	5,0	28,0	24790.0136	
M 6	20	24	12		15,0	5,0	29,0	24790.0138	
M 6	25	24	12		15,0	5,0	30,0	24790.0140	
M 6	30	24	12		15,0	5,0	31,0	24790.0142	
M 6	35	24	12		15,0	5,0	31,0	24790.0144	

d ₁	l	Abmessungen			h	k	 [g]	Art.-Nr.
		d ₂	d ₃	[mm]				
M 8	12	30	16	18,0	6,0	53,0	24790.0152	
M 8	16	30	16	18,0	6,0	55,0	24790.0154	
M 8	20	30	16	18,0	6,0	56,0	24790.0156	
M 8	25	30	16	18,0	6,0	58,0	24790.0158	
M 8	30	30	16	18,0	6,0	60,0	24790.0160	
M 8	35	30	16	18,0	6,0	60,0	24790.0162	
M 8	40	30	16	18,0	6,0	61,0	24790.0164	
M10	15	36	20	23,0	8,0	104,0	24790.0171	
M10	20	36	20	23,0	8,0	106,0	24790.0173	
M10	25	36	20	23,0	8,0	109,0	24790.0175	
M10	30	36	20	23,0	8,0	112,0	24790.0177	
M10	35	36	20	23,0	8,0	116,0	24790.0179	
M10	40	36	20	23,0	8,0	116,0	24790.0181	
Rostfreier Stahl								
M 3	6	12	6	7,5	2,5	3,7	24790.0274	
M 3	10	12	6	7,5	2,5	3,8	24790.0276	
M 3	12	12	6	7,5	2,5	4,0	24790.0277	
M 3	16	12	6	7,5	2,5	4,0	24790.0279	
M 4	8	16	8	9,5	3,5	7,9	24790.0294	
M 4	10	16	8	9,5	3,5	8,1	24790.0295	
M 4	12	16	8	9,5	3,5	8,3	24790.0296	
M 4	16	16	8	9,5	3,5	8,4	24790.0298	
M 4	20	16	8	9,5	3,5	9,1	24790.0300	
M 4	25	16	8	9,5	3,5	9,0	24790.0302	
M 5	10	20	10	11,5	4,0	15,0	24790.0314	
M 5	12	20	10	11,5	4,0	15,0	24790.0315	
M 5	16	20	10	11,5	4,0	16,0	24790.0317	
M 5	20	20	10	11,5	4,0	16,0	24790.0319	
M 5	25	20	10	11,5	4,0	17,0	24790.0321	
M 5	30	20	10	11,5	4,0	17,0	24790.0323	
M 6	12	24	12	15,0	5,0	28,0	24790.0334	
M 6	16	24	12	15,0	5,0	28,0	24790.0336	
M 6	20	24	12	15,0	5,0	29,0	24790.0338	
M 6	25	24	12	15,0	5,0	30,0	24790.0340	
M 6	30	24	12	15,0	5,0	31,0	24790.0342	
M 6	35	24	12	15,0	5,0	31,0	24790.0344	
M 8	16	30	16	18,0	6,0	55,0	24790.0354	
M 8	20	30	16	18,0	6,0	56,0	24790.0356	
M 8	25	30	16	18,0	6,0	58,0	24790.0358	
M 8	30	30	16	18,0	6,0	60,0	24790.0360	
M 8	35	30	16	18,0	6,0	60,0	24790.0362	

Anwendungsbeispiel

