

Positionierbuchsen mit Bund, DIN 172 A EH 23112.



Produktbeschreibung

Sie dienen beispielsweise in Bohrvorrichtungen als Führung und sorgen so für die gewünschte Wiederholgenauigkeit.

Die gehärteten und geschliffenen Positionierbuchsen können als verschleißfeste Führung für Bohrer, Wellen usw. verwendet werden.

Werkstoff

- Einsatzstahl, einsatzgehärtet

Maßzeichnung

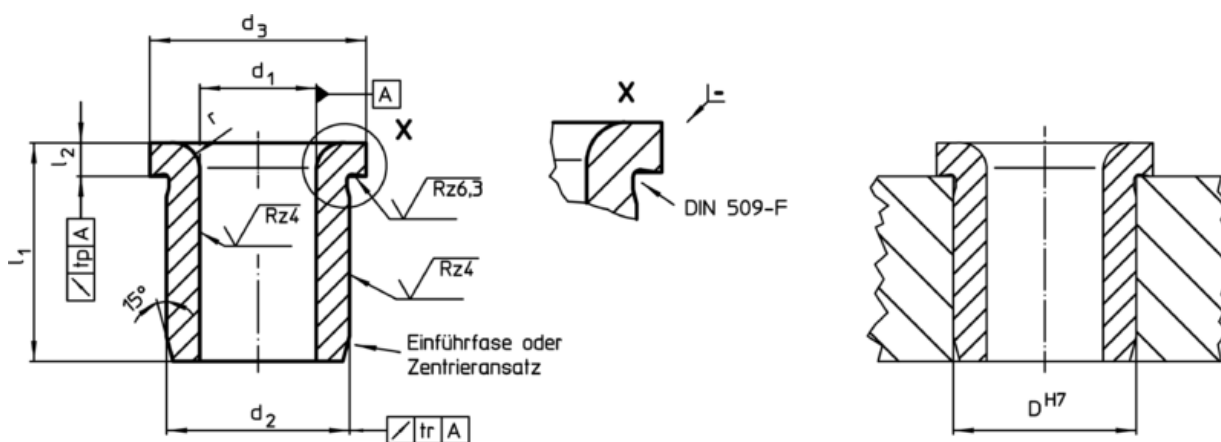

Bestellinformationen

| d ₁ F7 | l ₁ | Abmessungen | | | | l ₂ | r | Aufnahmebohrung D H7 [mm] | [g] | Art.-Nr. |
|----------------------|----------------|----------------------|----------------|------|-----|----------------|-----|------------------------------------|-----|----------|
| | | d ₂ n6 | d ₃ | [mm] | | | | | | |
| 2,0 | 6 | 5 | 8 | 2,0 | 1,0 | 5 | 1,2 | 23112.0020 | | |
| 2,0 | 9 | 5 | 8 | 2,0 | 1,0 | 5 | 1,6 | 23112.0021 | | |
| 2,1 | 6 | 5 | 8 | 2,0 | 1,0 | 5 | 1,2 | 23112.0022 | | |
| 2,1 | 9 | 5 | 8 | 2,0 | 1,0 | 5 | 1,5 | 23112.0023 | | |
| 2,5 | 6 | 5 | 8 | 2,0 | 1,0 | 5 | 1,1 | 23112.0024 | | |
| 2,5 | 9 | 5 | 8 | 2,0 | 1,0 | 5 | 1,4 | 23112.0025 | | |
| 3,0 | 8 | 6 | 9 | 2,5 | 1,0 | 6 | 1,9 | 23112.0030 | | |
| 3,0 | 12 | 6 | 9 | 2,5 | 1,0 | 6 | 2,6 | 23112.0031 | | |
| 3,0 | 16 | 6 | 9 | 2,5 | 1,0 | 6 | 3,2 | 23112.0032 | | |
| 3,1 | 8 | 6 | 9 | 2,5 | 1,0 | 6 | 1,9 | 23112.0033 | | |
| 3,1 | 12 | 6 | 9 | 2,5 | 1,0 | 6 | 2,5 | 23112.0034 | | |
| 3,1 | 16 | 6 | 9 | 2,5 | 1,0 | 6 | 3,2 | 23112.0035 | | |
| 3,5 | 8 | 7 | 10 | 2,5 | 1,0 | 7 | 2,4 | 23112.0036 | | |
| 3,5 | 12 | 7 | 10 | 2,5 | 1,0 | 7 | 3,4 | 23112.0037 | | |
| 3,5 | 16 | 7 | 10 | 2,5 | 1,0 | 7 | 4,3 | 23112.0038 | | |
| 4,0 | 8 | 7 | 10 | 2,5 | 1,0 | 7 | 2,3 | 23112.0040 | | |
| 4,0 | 12 | 7 | 10 | 2,5 | 1,0 | 7 | 3,1 | 23112.0041 | | |
| 4,0 | 16 | 7 | 10 | 2,5 | 1,0 | 7 | 3,9 | 23112.0042 | | |
| 4,1 | 8 | 8 | 11 | 2,5 | 1,0 | 8 | 3,0 | 23112.0043 | | |
| 4,1 | 12 | 8 | 11 | 2,5 | 1,0 | 8 | 4,2 | 23112.0044 | | |
| 4,1 | 16 | 8 | 11 | 2,5 | 1,0 | 8 | 5,3 | 23112.0045 | | |
| 4,5 | 8 | 8 | 11 | 2,5 | 1,0 | 8 | 2,9 | 23112.0046 | | |
| 4,5 | 12 | 8 | 11 | 2,5 | 1,0 | 8 | 3,9 | 23112.0047 | | |

| d ₁ F7 | l ₁ | Abmessungen | | | | l ₂ | r | Aufnahmebohrung D H7 [mm] |  [g] | Art.-Nr. |
|----------------------|----------------|----------------------|----------------|------|-----|----------------|------|------------------------------------|--|----------|
| | | d ₂ n6 | d ₃ | [mm] | | | | | | |
| 4,5 | 16 | 8 | 11 | 2,5 | 1,0 | 8 | 5,0 | 23112.0048 | | |
| 5,0 | 8 | 8 | 11 | 2,5 | 1,0 | 8 | 2,6 | 23112.0050 | | |
| 5,0 | 12 | 8 | 11 | 2,5 | 1,0 | 8 | 3,6 | 23112.0051 | | |
| 5,0 | 16 | 8 | 11 | 2,5 | 1,0 | 8 | 4,5 | 23112.0052 | | |
| 5,1 | 10 | 10 | 13 | 3,0 | 1,5 | 10 | 5,5 | 23112.0053 | | |
| 5,1 | 16 | 10 | 13 | 3,0 | 1,5 | 10 | 8,2 | 23112.0054 | | |
| 5,1 | 20 | 10 | 13 | 3,0 | 1,5 | 10 | 10,0 | 23112.0055 | | |
| 5,5 | 10 | 10 | 13 | 3,0 | 1,5 | 10 | 5,3 | 23112.0056 | | |
| 5,5 | 16 | 10 | 13 | 3,0 | 1,5 | 10 | 7,9 | 23112.0057 | | |
| 5,5 | 20 | 10 | 13 | 3,0 | 1,5 | 10 | 9,6 | 23112.0058 | | |
| 6,0 | 10 | 10 | 13 | 3,0 | 1,5 | 10 | 4,9 | 23112.0060 | | |
| 6,0 | 16 | 10 | 13 | 3,0 | 1,5 | 10 | 7,3 | 23112.0061 | | |
| 6,0 | 20 | 10 | 13 | 3,0 | 1,5 | 10 | 8,8 | 23112.0062 | | |
| 6,1 | 10 | 12 | 15 | 3,0 | 1,5 | 12 | 7,7 | 23112.0063 | | |
| 6,1 | 16 | 12 | 15 | 3,0 | 1,5 | 12 | 12,0 | 23112.0064 | | |
| 6,1 | 20 | 12 | 15 | 3,0 | 1,5 | 12 | 14,0 | 23112.0065 | | |
| 6,5 | 10 | 12 | 15 | 3,0 | 1,5 | 12 | 7,4 | 23112.0066 | | |
| 6,5 | 16 | 12 | 15 | 3,0 | 1,5 | 12 | 11,0 | 23112.0067 | | |
| 6,5 | 20 | 12 | 15 | 3,0 | 1,5 | 12 | 14,0 | 23112.0068 | | |
| 7,0 | 10 | 12 | 15 | 3,0 | 1,5 | 12 | 7,0 | 23112.0070 | | |
| 7,0 | 16 | 12 | 15 | 3,0 | 1,5 | 12 | 10,0 | 23112.0071 | | |
| 7,0 | 20 | 12 | 15 | 3,0 | 1,5 | 12 | 13,0 | 23112.0072 | | |
| 7,1 | 10 | 12 | 15 | 3,0 | 1,5 | 12 | 6,9 | 23112.0073 | | |
| 7,1 | 16 | 12 | 15 | 3,0 | 1,5 | 12 | 10,0 | 23112.0074 | | |
| 7,1 | 20 | 12 | 15 | 3,0 | 1,5 | 12 | 13,0 | 23112.0075 | | |
| 7,5 | 10 | 12 | 15 | 3,0 | 1,5 | 12 | 6,5 | 23112.0076 | | |
| 7,5 | 16 | 12 | 15 | 3,0 | 1,5 | 12 | 9,7 | 23112.0077 | | |
| 7,5 | 20 | 12 | 15 | 3,0 | 1,5 | 12 | 12,0 | 23112.0078 | | |
| 8,0 | 10 | 12 | 15 | 3,0 | 1,5 | 12 | 6,0 | 23112.0080 | | |
| 8,0 | 16 | 12 | 15 | 3,0 | 1,5 | 12 | 9,0 | 23112.0081 | | |
| 8,0 | 20 | 12 | 15 | 3,0 | 1,5 | 12 | 11,0 | 23112.0082 | | |
| 8,1 | 12 | 15 | 18 | 3,0 | 2,0 | 15 | 13,0 | 23112.0083 | | |
| 8,1 | 20 | 15 | 18 | 3,0 | 2,0 | 15 | 25,0 | 23112.0084 | | |
| 8,1 | 25 | 15 | 18 | 3,0 | 2,0 | 15 | 26,0 | 23112.0085 | | |
| 8,5 | 12 | 15 | 18 | 3,0 | 2,0 | 15 | 13,0 | 23112.0086 | | |
| 8,5 | 20 | 15 | 18 | 3,0 | 2,0 | 15 | 20,0 | 23112.0087 | | |
| 8,5 | 25 | 15 | 18 | 3,0 | 2,0 | 15 | 25,0 | 23112.0088 | | |
| 9,0 | 12 | 15 | 18 | 3,0 | 2,0 | 15 | 12,0 | 23112.0090 | | |
| 9,0 | 20 | 15 | 18 | 3,0 | 2,0 | 15 | 19,0 | 23112.0091 | | |
| 9,0 | 25 | 15 | 18 | 3,0 | 2,0 | 15 | 23,0 | 23112.0092 | | |
| 9,1 | 12 | 15 | 18 | 3,0 | 2,0 | 15 | 12,0 | 23112.0093 | | |
| 9,1 | 20 | 15 | 18 | 3,0 | 2,0 | 15 | 19,0 | 23112.0094 | | |
| 9,1 | 25 | 15 | 18 | 3,0 | 2,0 | 15 | 23,0 | 23112.0095 | | |
| 9,5 | 12 | 15 | 18 | 3,0 | 2,0 | 15 | 11,0 | 23112.0096 | | |
| 9,5 | 20 | 15 | 18 | 3,0 | 2,0 | 15 | 18,0 | 23112.0097 | | |
| 9,5 | 25 | 15 | 18 | 3,0 | 2,0 | 15 | 22,0 | 23112.0098 | | |
| 10,0 | 12 | 15 | 18 | 3,0 | 2,0 | 15 | 11,0 | 23112.0100 | | |
| 10,0 | 20 | 15 | 18 | 3,0 | 2,0 | 15 | 17,0 | 23112.0101 | | |
| 10,0 | 25 | 15 | 18 | 3,0 | 2,0 | 15 | 20,0 | 23112.0102 | | |
| 10,1 | 12 | 18 | 22 | 4,0 | 2,0 | 18 | 20,0 | 23112.0103 | | |
| 10,1 | 20 | 18 | 22 | 4,0 | 2,0 | 18 | 30,0 | 23112.0104 | | |
| 10,1 | 25 | 18 | 22 | 4,0 | 2,0 | 18 | 37,0 | 23112.0105 | | |
| 10,5 | 12 | 18 | 22 | 4,0 | 2,0 | 18 | 19,0 | 23112.0106 | | |
| 10,5 | 20 | 18 | 22 | 4,0 | 2,0 | 18 | 29,0 | 23112.0107 | | |
| 10,5 | 25 | 18 | 22 | 4,0 | 2,0 | 18 | 36,0 | 23112.0108 | | |
| 11,0 | 12 | 18 | 22 | 4,0 | 2,0 | 18 | 18,0 | 23112.0110 | | |
| 11,0 | 20 | 18 | 22 | 4,0 | 2,0 | 18 | 28,0 | 23112.0111 | | |
| 11,0 | 25 | 18 | 22 | 4,0 | 2,0 | 18 | 34,0 | 23112.0112 | | |
| 11,1 | 12 | 18 | 22 | 4,0 | 2,0 | 18 | 18,0 | 23112.0113 | | |
| 11,1 | 20 | 18 | 22 | 4,0 | 2,0 | 18 | 28,0 | 23112.0114 | | |
| 11,1 | 25 | 18 | 22 | 4,0 | 2,0 | 18 | 34,0 | 23112.0115 | | |

| d ₁ F7 | l ₁ | Abmessungen | | | | l ₂ | r | Aufnahmebohrung D H7 [mm] |  [g] | Art.-Nr. |
|----------------------|----------------|----------------------|----------------|------|-----|----------------|-------|------------------------------------|--|----------|
| | | d ₂ n6 | d ₃ | [mm] | | | | | | |
| 11,5 | 12 | 18 | 22 | 4,0 | 2,0 | 18 | 17,0 | 23112.0116 | | |
| 11,5 | 20 | 18 | 22 | 4,0 | 2,0 | 18 | 26,0 | 23112.0117 | | |
| 11,5 | 25 | 18 | 22 | 4,0 | 2,0 | 18 | 33,0 | 23112.0118 | | |
| 12,0 | 12 | 18 | 22 | 4,0 | 2,0 | 18 | 16,0 | 23112.0120 | | |
| 12,0 | 20 | 18 | 22 | 4,0 | 2,0 | 18 | 25,0 | 23112.0121 | | |
| 12,0 | 25 | 18 | 22 | 4,0 | 2,0 | 18 | 31,0 | 23112.0122 | | |
| 12,1 | 16 | 22 | 26 | 4,0 | 2,0 | 22 | 37,0 | 23112.0123 | | |
| 12,1 | 28 | 22 | 26 | 4,0 | 2,0 | 22 | 62,0 | 23112.0124 | | |
| 12,1 | 36 | 22 | 26 | 4,0 | 2,0 | 22 | 78,0 | 23112.0125 | | |
| 12,5 | 16 | 22 | 26 | 4,0 | 2,0 | 22 | 36,0 | 23112.0126 | | |
| 12,5 | 28 | 22 | 26 | 4,0 | 2,0 | 22 | 60,0 | 23112.0127 | | |
| 12,5 | 36 | 22 | 26 | 4,0 | 2,0 | 22 | 76,0 | 23112.0128 | | |
| 13,0 | 16 | 22 | 26 | 4,0 | 2,0 | 22 | 34,0 | 23112.0130 | | |
| 13,0 | 28 | 22 | 26 | 4,0 | 2,0 | 22 | 58,0 | 23112.0131 | | |
| 13,0 | 36 | 22 | 26 | 4,0 | 2,0 | 22 | 73,0 | 23112.0132 | | |
| 14,0 | 16 | 22 | 26 | 4,0 | 2,0 | 22 | 32,0 | 23112.0140 | | |
| 14,0 | 28 | 22 | 26 | 4,0 | 2,0 | 22 | 53,0 | 23112.0141 | | |
| 14,0 | 36 | 22 | 26 | 4,0 | 2,0 | 22 | 67,0 | 23112.0142 | | |
| 15,0 | 16 | 22 | 26 | 4,0 | 2,0 | 22 | 29,0 | 23112.0150 | | |
| 15,0 | 28 | 22 | 26 | 4,0 | 2,0 | 22 | 48,0 | 23112.0151 | | |
| 15,0 | 36 | 22 | 26 | 4,0 | 2,0 | 22 | 61,0 | 23112.0152 | | |
| 16,0 | 16 | 26 | 30 | 4,0 | 2,0 | 26 | 45,0 | 23112.0160 | | |
| 16,0 | 28 | 26 | 30 | 4,0 | 2,0 | 26 | 76,0 | 23112.0161 | | |
| 16,0 | 36 | 26 | 30 | 4,0 | 2,0 | 26 | 97,0 | 23112.0162 | | |
| 16,1 | 16 | 26 | 30 | 4,0 | 2,0 | 26 | 45,0 | 23112.0163 | | |
| 16,1 | 28 | 26 | 30 | 4,0 | 2,0 | 26 | 76,0 | 23112.0164 | | |
| 16,1 | 36 | 26 | 30 | 4,0 | 2,0 | 26 | 96,0 | 23112.0165 | | |
| 16,5 | 16 | 26 | 30 | 4,0 | 2,0 | 26 | 44,0 | 23112.0166 | | |
| 16,5 | 28 | 26 | 30 | 4,0 | 2,0 | 26 | 73,0 | 23112.0167 | | |
| 16,5 | 36 | 26 | 30 | 4,0 | 2,0 | 26 | 93,0 | 23112.0168 | | |
| 17,0 | 16 | 26 | 30 | 4,0 | 2,0 | 26 | 42,0 | 23112.0171 | | |
| 17,0 | 28 | 26 | 30 | 4,0 | 2,0 | 26 | 70,0 | 23112.0172 | | |
| 17,0 | 36 | 26 | 30 | 4,0 | 2,0 | 26 | 90,0 | 23112.0173 | | |
| 18,0 | 16 | 26 | 30 | 4,0 | 2,0 | 26 | 39,0 | 23112.0181 | | |
| 18,0 | 28 | 26 | 30 | 4,0 | 2,0 | 26 | 64,0 | 23112.0182 | | |
| 18,0 | 36 | 26 | 30 | 4,0 | 2,0 | 26 | 82,0 | 23112.0183 | | |
| 19,0 | 20 | 30 | 34 | 5,0 | 3,0 | 30 | 71,0 | 23112.0191 | | |
| 19,0 | 36 | 30 | 34 | 5,0 | 3,0 | 30 | 125,0 | 23112.0192 | | |
| 19,0 | 45 | 30 | 34 | 5,0 | 3,0 | 30 | 154,0 | 23112.0193 | | |
| 20,0 | 20 | 30 | 34 | 5,0 | 3,0 | 30 | 67,0 | 23112.0201 | | |
| 20,0 | 36 | 30 | 34 | 5,0 | 3,0 | 30 | 117,0 | 23112.0202 | | |
| 20,0 | 45 | 30 | 34 | 5,0 | 3,0 | 30 | 143,0 | 23112.0203 | | |
| 20,1 | 20 | 30 | 34 | 5,0 | 3,0 | 30 | 66,0 | 23112.0204 | | |
| 20,1 | 36 | 30 | 34 | 5,0 | 3,0 | 30 | 115,0 | 23112.0205 | | |
| 20,1 | 45 | 30 | 34 | 5,0 | 3,0 | 30 | 142,0 | 23112.0206 | | |
| 22,0 | 20 | 30 | 34 | 5,0 | 3,0 | 30 | 56,0 | 23112.0221 | | |
| 22,0 | 36 | 30 | 34 | 5,0 | 3,0 | 30 | 97,0 | 23112.0222 | | |
| 22,0 | 45 | 30 | 34 | 5,0 | 3,0 | 30 | 120,0 | 23112.0223 | | |
| 25,0 | 20 | 35 | 39 | 5,0 | 3,0 | 35 | 80,0 | 23112.0251 | | |
| 25,0 | 36 | 35 | 39 | 5,0 | 3,0 | 35 | 138,0 | 23112.0252 | | |
| 25,0 | 45 | 35 | 39 | 5,0 | 3,0 | 35 | 171,0 | 23112.0253 | | |
| 30,0 | 25 | 42 | 46 | 5,0 | 3,0 | 42 | 139,0 | 23112.0301 | | |
| 30,0 | 45 | 42 | 46 | 5,0 | 3,0 | 42 | 245,0 | 23112.0302 | | |
| 30,0 | 56 | 42 | 46 | 5,0 | 3,0 | 42 | 304,0 | 23112.0303 | | |