

Mounting instruction



Full extension pantry slide

SCHOCK
M E T A L L

Mounting instruction for Schock pantry slide

valid for set no. 059.11099 and other lengths identical in construction



Fix mounting brackets to bottom of wooden drawer. Drill a hole for front adjustment screw.



Fix bottom slide unit to the bottom of cabinet. Please use all available attachment points.

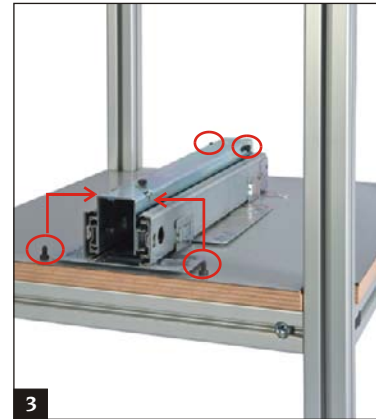

Insert two screws into the rear holes and screw half way in. Deposit two screws for front mounting bracket.



Fix top slide unit to the top of cabinet.



Pull out inner member of top slide unit.



Lift wooden drawer with two people.



Insert the bolts of the top slide unit into the drawer.

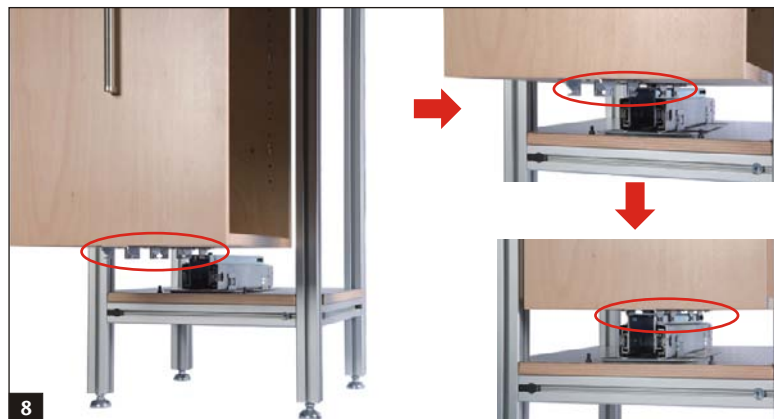

Push drawer on the u-profile of the bottom slide unit.

Mounting instruction for Schock pantry slide



9
Pull out drawer.



10
Adjust front panel by twisting front adjustment screw.



11
Tighten front and rear screws of both mounting brackets.



12
Push in drawer - finished!

- **Load capacity up to 120 kg**
- **50 mm self-closing device with damper in both bottom and top slide unit**
- **Installation measures see rear page**

Design information

Installation measures

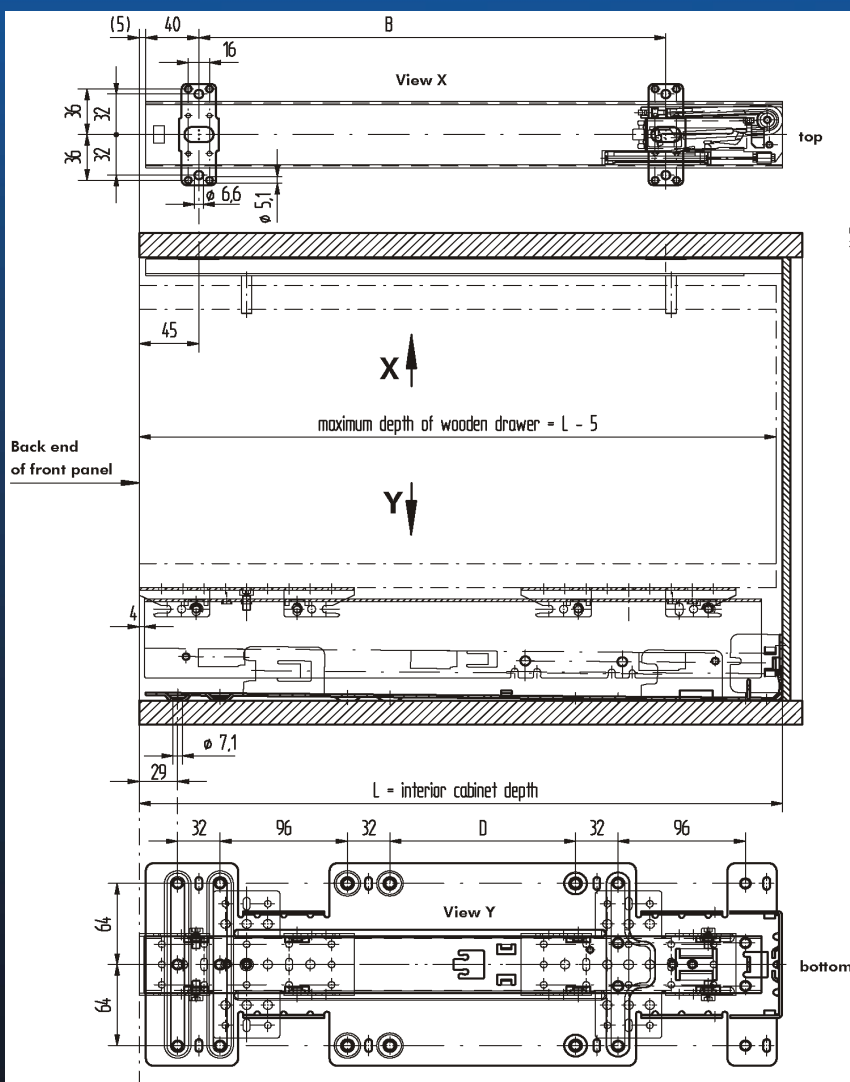

Set-No. *	L	A	B	C	D
059.11098	455	288	352	256	110
059.11099	485	320	352	288	140
059.11100	505	320	384	288	160
059.11101	605	416	416	416	260

* = bottom + top slide unit packed per set

Hole pattern for wooden drawer:

