



# MBK410C

## Ceiling mounting bracket for NOBA8(A)

### Product information:

The MBK410C is a mounting bracket system for fixation of NOBA8(A) speakers on any ceiling. It allows central positioning for directional placement to guarantee the optimal sound coverage throughout the area.

It is composed of a ceiling section and speaker section which can be hooked with each other. This guarantees great installers convenience for fixing the ceiling section on the desired location, while the speaker can be hooked afterwards. The hinge type structure allows easy access to the internal connectors. A duct keeps the cables in position and avoids them touching the speaker cone.

The construction is made of solid and powder coated steel material and comes available in both black (/B) and white (/W) colors for matching the speakers.



### Product Features:

Dimensions	509 x 198 x 34 mm (W x H x D)	
Weight	1,15 kg	
Construction	Steel	
Accessories	Included	Mounting bracket

### Variants:

- MBK410C/B - Black
- MBK410C/W - White

### Shipping & Ordering:

Packaging	Cardboard box
Shipping weight & volume	1,26 kg - 0,005 Cbm

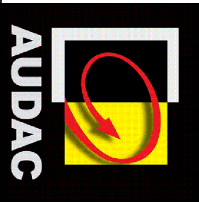
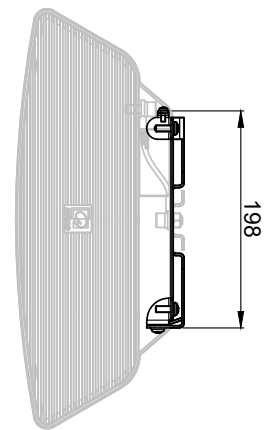
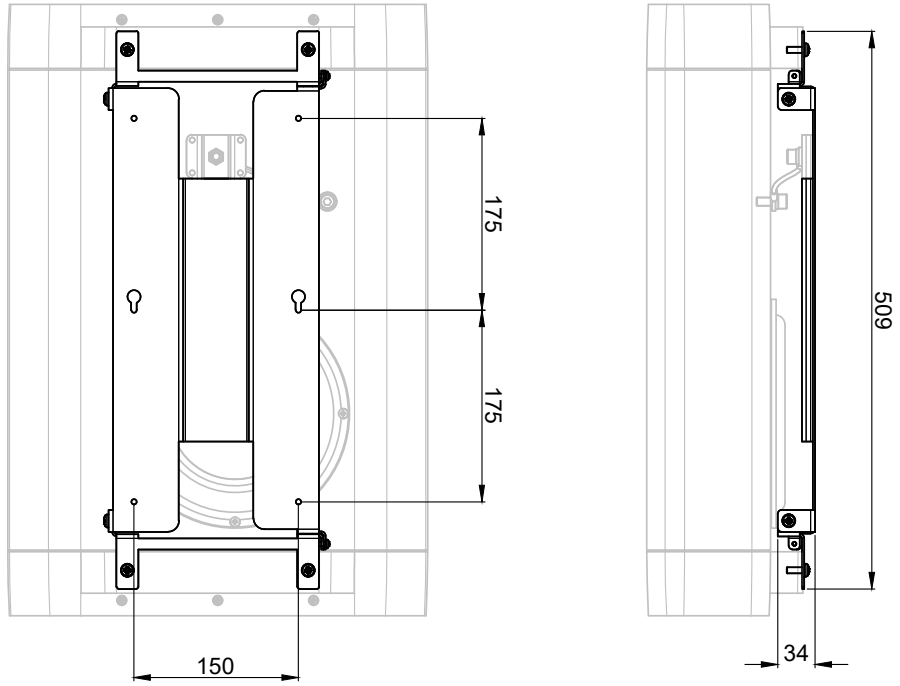

<b>MBK410C</b>		<b>Product description:</b> CEILING MOUNT BRACKET FOR NOBA8(A)	
<b>Weight:</b>	TBA	<b>Outer dimensions:</b> (w x h x d)	509 x 34 x 198
<b>Unit height:</b>	N/A		