

## **CS-S Series**

**Surface Speakers: passive and 100/70 V-line**

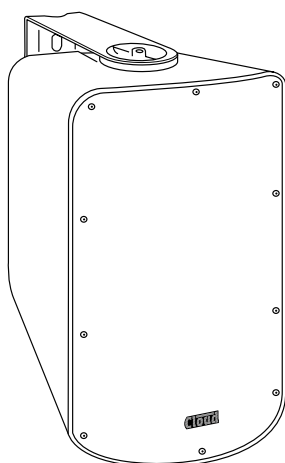

**CS-S8**

8" SURFACE MOUNT LOUDSPEAKER

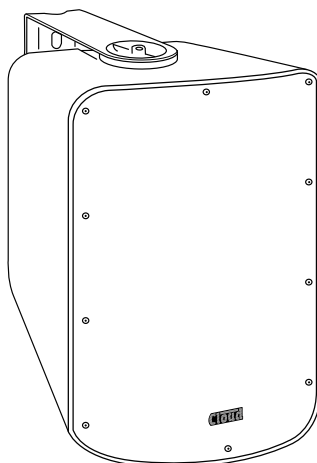

**CS-S10**

10" SURFACE MOUNT LOUDSPEAKER

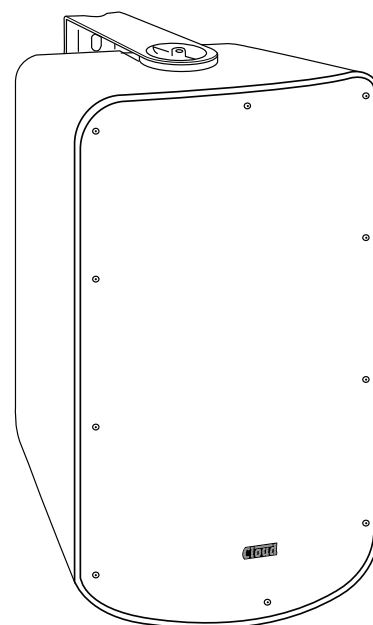

**CS-S12**

12" SURFACE MOUNT LOUDSPEAKER

## **Installation Guide**



## CAUTION - Installation

The speaker must be installed by a qualified speaker technician.



## CAUTION - Installation

Do not perform servicing unless you are qualified to do so. The speaker contains no user-serviceable parts. Refer servicing to qualified personnel.



## CAUTION - Installation

Be aware of the weight of the speaker and bracket. Ensure that a safety factor of at least 2x is used when specifying the bracket fixings.

## WEIGHTS OF SPEAKERS AND ACCESSORIES:

### Speakers:

Model	Net weight
CS-S8	8.2 kg (18.0 lb)
CS-S8T	9.1 kg (20.0 lb)
CS-S10	10.3 kg (23.2 lb)
CS-S10T	11.4 kg (25.5 lb)
CS-S12	15.4 kg (34.6 lb)
CS-S12T	17.0 kg (38.1 lb)

### Accessories:

Accessory	Net weight
CS-810BKT	2.1 kg (4.6 lb)
CS-12BKT	2.7 kg (6.1 lb)
CS-IP66	0.75 kg (1.65 lb)

## Conformities

**IP66 rating:** the speakers covered by this Installation Guide meet the requirements of protection rating IP66 (no dust ingress, resistant to powerful water jets) when fitted with the CS-IP66 rear plate accessory. The speakers should not be installed in an outdoor environment without this plate.

# OVERVIEW

## Introduction

The Cloud CS-S loudspeakers are primarily intended for internal or external installation in leisure and hospitality venues. They are high quality, two-way units using Dual Concentric drivers, and are suitable for music reproduction at a higher sound level than normal “background music” speakers. The Dual Concentric design delivers even dispersion in the horizontal and vertical planes, providing exceptional off-axis performance.

## Applicable models

This Installation Guide covers the following CS-S versions:

- CS-S8: 8” LF driver, suitable for low-impedance operation
- CS-S8T: 8” LF driver, suitable for 70/100 V-line systems (with lo-Z option)
- CS-S10: 10” LF driver, suitable for low-impedance operation
- CS-S10T: 10” LF driver, suitable for 70/100 V-line systems (with lo-Z option)
- CS-S12: 12” LF driver, suitable for low-impedance operation
- CS-S12T: 12” LF driver, suitable for 70/100 V-line systems (with lo-Z option)

NOTE: The model number of all versions will have an additional suffix ‘B’ or ‘W’, denoting the finish colour of black or white.

NOTE: Active versions of the CS-S range will include the suffix ‘A’ or ‘D’ in the model number. The installation and operation of these is covered in a separate Guide.

## INSTALLATION

### Step 1

Remove speaker from shipping carton.

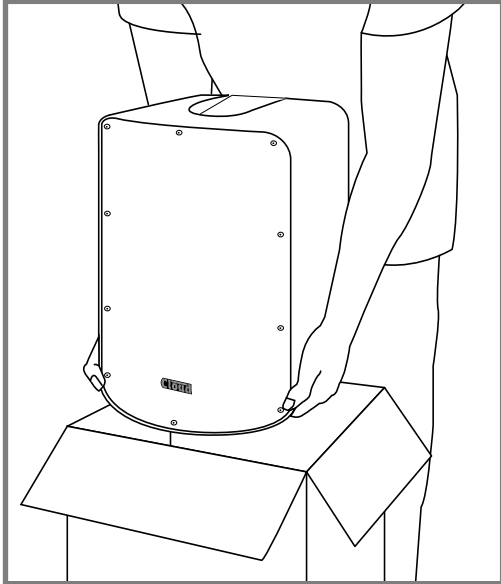

### Installation with the standard bracket

Several mounting options are available for CS-S8/10/12 speakers. The most usual method will be on-wall mounting using the optional Cloud mounting brackets. The brackets are:

- CS-810BKT for versions CS-S8, CS-8T, CS-10 and CS-S10T
- CS-12BKT for versions CS-S12 and CS-S12T

### Step 2:

Brackets will be packed and shipped separately. Unpack the bracket.

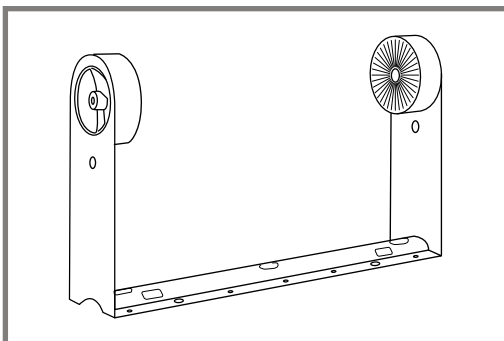

Note the bracket's main rear strut is dished for cable management. The loudspeaker cable(s) should be approximately in position before the bracket is fixed to the wall. (Note that a second cable will be needed if the CS-S's Link feature is to be used.) The cable(s) can then be passed behind the rear strut and brought through one of large holes prior to the bracket being fixed. Cut the cable(s) to an appropriate length.

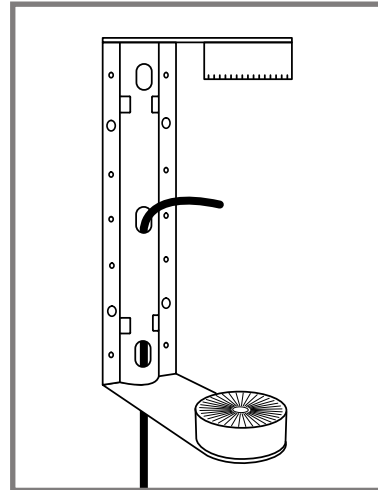

### Step 3:

The speaker may be installed either vertically or horizontally. Fix the bracket to the wall accordingly, using the ten fixing holes. Only use fixings appropriate for the wall material and observe the safety factor and the weight of the speaker/ bracket combination given in the table on page 2.

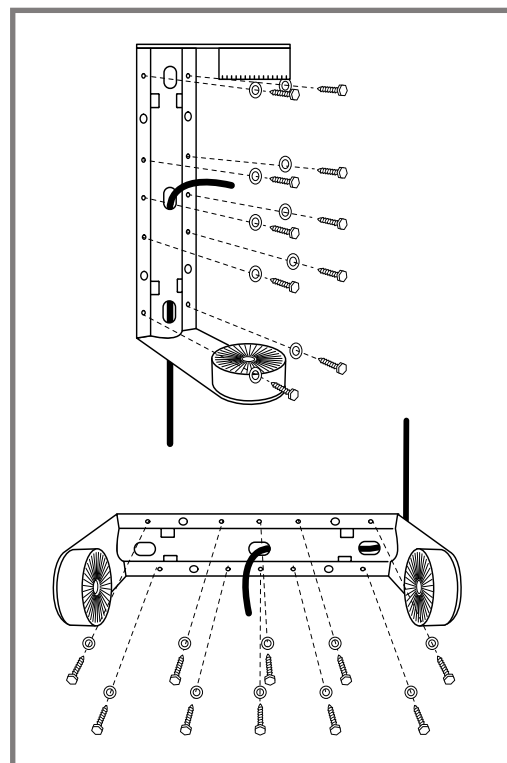

#### Step 4:

A stainless steel wire safety cable is supplied with the bracket. The looped end should ideally be attached to a convenient, substantial anchor point that is part of the building structure. It may be necessary to fit a dedicated bolt or similar to a suitable part of the structure in order to obtain a safe fixing.

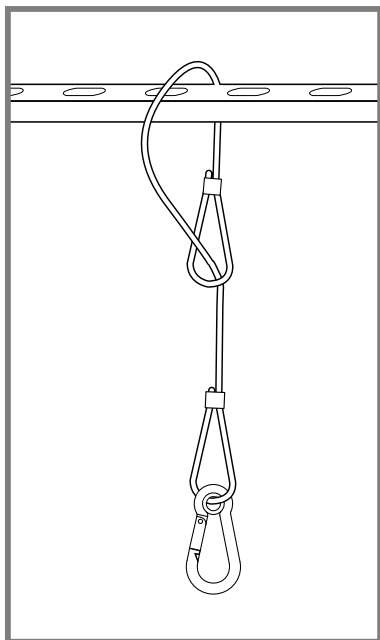

If no such fixing point is available, feed the looped end through two of the rectangular slots in the bracket's rear strut and pass the other end through the loop.

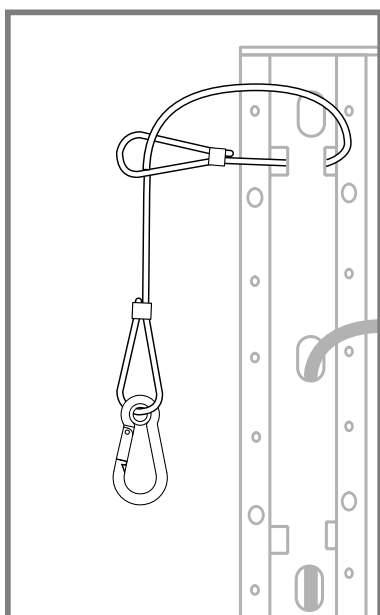

#### Step 5:

The speaker should now be fitted to the bracket. Push the rear of the cabinet squarely between the bracket's clamps and continue pushing until the clamps lock into place. The speaker can now be freely rotated to allow access to the rear panel.

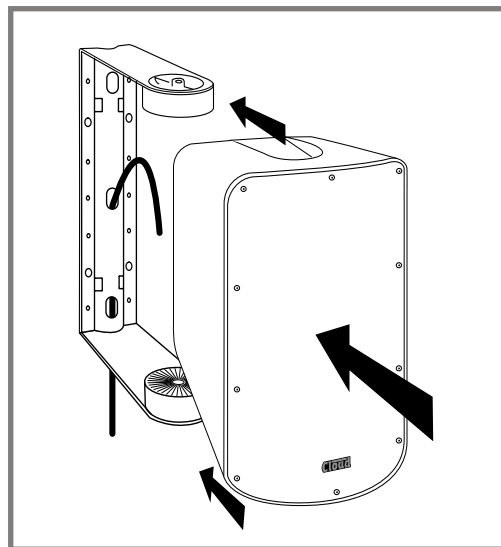

#### Step 6 (optional):

If the CS-IP66 rear protection plate is to be fitted, the cable(s) should now be fed through the cable gland(s) in the plate. Leave the gland(s) loose for now.

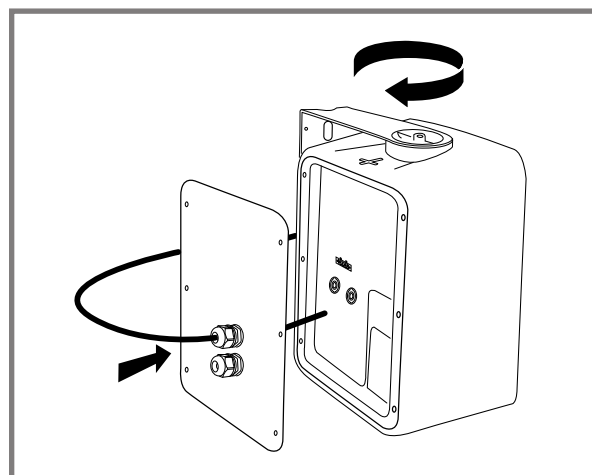

#### Step 7:

Fit the connector(s) to the cable(s). Use either the 4-pin 5 mm-pitch Euroblock connector or the Neutrik NL4 Speakon® connector(s). A mating, locking-type Euroblock connector is supplied with the speaker.

**NOTE:** if the CS-IP66 rear plate is to be fitted, **only** the Euroblock connector can be used.

a) Euroblock wiring is as below:

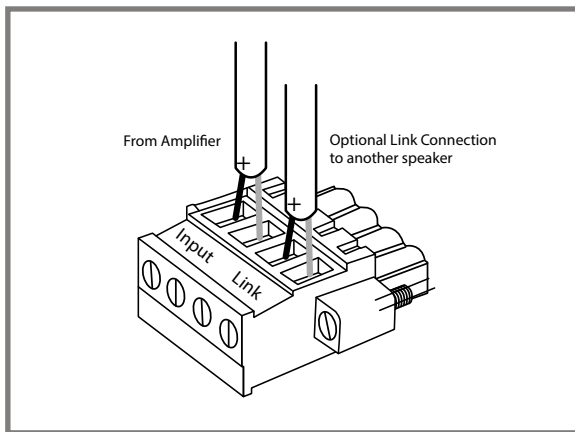

OR

b) Speakon wiring is as per the table below. The wiring of the **INPUT** and **LINK** connectors is identical. Note that pins '1+' and '2+' are wired in parallel internally, and pins '1-' and '2-' are wired in parallel internally. Either pin of each pair may be used.

PIN	USE
1+	Signal '+' (hot)
1-	Signal '-' (cold)
2+	Paralleled to '1+'
2-	Paralleled to '1-'

## Step 8:

Plug in the rear connectors that were wired in Step 7.

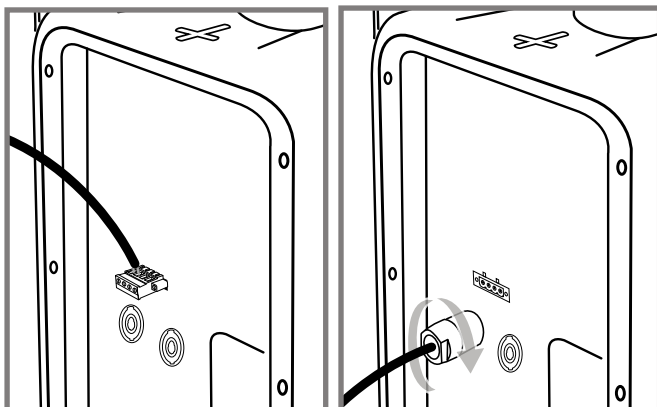

The Eurobloc connector may be locked in place by tightening the two locking screws. The Speakon connector(s) may be locked in place by rotating them until they click.

## Step 9 ('T' versions only)

Speaker versions CS-S8T, CS-S10T and CS-S12T have an internal multi-tap transformer allowing them to be used in a 70/100V-line distribution system. The 6-position rotary switch on the rear panel selects the tap setting, and this is best done before locking the speaker in its final position.

The available power ratings vary with the three loudspeaker sizes, and are summarised below:

Tap	Power settings					
	CS-S8T		CS-S10T		CS-S12T	
	70 V	100V	70 V	100V	70 V	100V
1	8 ohms					
2	OFF					
3	8 W	16 W	12.5 W	25 W	18.75 W	37.5 W
4	16 W	32 W	25 W	50 W	37.5 W	75 W
5	32 W	64 W	50 W	100 W	75 W	150 W
6	64 W	(n/u)	100 W	(n/u)	150 W	(n/u)

The power settings for the speaker are also indicated on the rear panel, for both 70 V-line and 100 V-line operation.

Note that the switch also has an OFF setting (mutes the speaker, but LINK is still active), and an 8 ohm setting (transformer by-passed). The 8 ohm position is indicated by a 'Ω' symbol.

## Step 10 (optional)

If fitting a CS-IP66 rear plate, it may now be fixed in place. Feed the cable(s) back through the cable gland(s) to lose any slack as necessary and finger-tighten the gland(s). The plate is fixed using the six M5 x 12 mm hex head screws supplied with the plate. When the plate is fixed, fully tighten the cable gland(s).

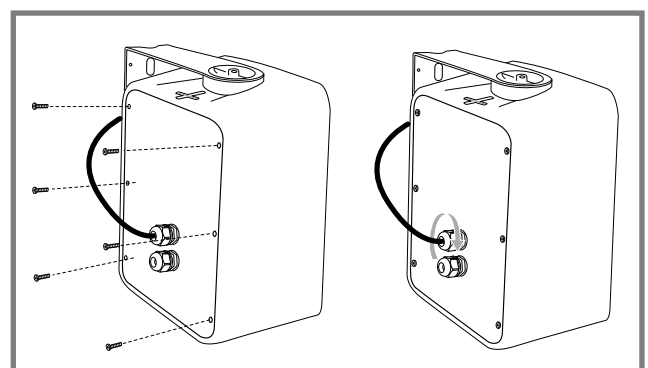

## Step 11

Secure the safety cable's carabiner hook to the locking loop on the rear of the cabinet

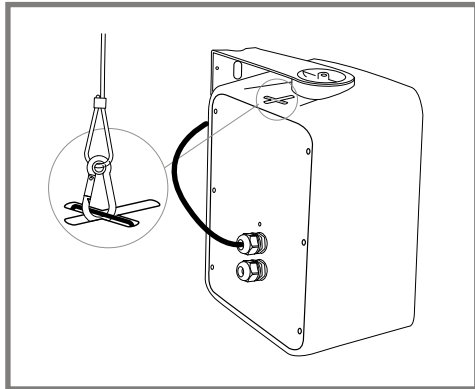

The speaker may now be rotated to its desired position. Lock it in place by tightening the two bracket clamps.

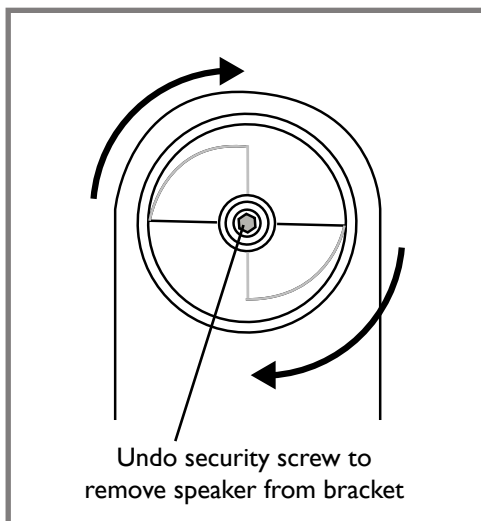

**NOTE:** the clamp design is a security feature. Once tightened, they can only be loosened by undoing the central screw with a 5 mm a/f hex key.

## Step 12

If necessary, rotate the Cloud badge on the front grille to suit the final orientation of the speaker.

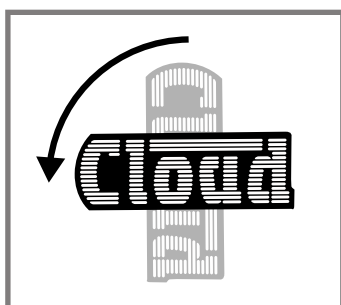

## Other installation options

### Ceiling mounting

Various OEM top-mount brackets may be used to “hang” CS-S8/10/12 speakers in a vertical orientation using the four M6 tapped sockets on the bottom of the cabinet. In such an installation, the speaker would be “upside-down” relative to the rear panel silk-screening, but poses no issues for normal speaker operation.

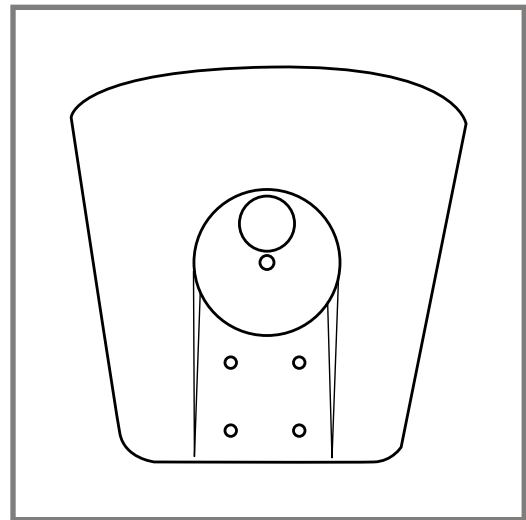

Cloud has tested and approved the Powerdrive CMT60 Bracket for this purpose, for loads up to 18 kg.

See <https://mypowerdrive.com/products/top-mount-ceiling-bracket-cmft60-b?id=1737> for more information.

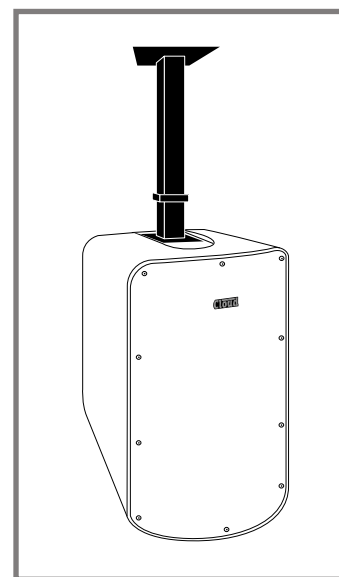

Powerdrive can also supply various other mounting solutions which use these M6 mounting points.

See <https://mypowerdrive.com/> for more information.

## Pole/spigot mounting

CS-S8/10/12 speakers have a standard 35 mm “top hat” mounting socket in both top and bottom of the cabinet. These allow the speakers to be mounted in vertical orientation on a variety of OEM wall brackets fitted with 35 mm spigots.

Some bracket designs utilise both sockets, others only the bottom socket.

Cloud approve the Powerdrive WHU-35B bracket for this purpose. See <https://mypowerdrive.com/products/bottom-mount-wall-bracket-35mm-spigot-whu35-b?id=2144> for more information.

## Free-standing use

The bottom “top hat” socket may also be used with most standard OEM tripod floor stands with a 35 mm spigot, greatly increasing the speakers’ versatility.

